

B A Y S I D E S U R V E Y I N G

6205 Short Street
Bay City, Oregon 97107

Terry L. Jones
503-377-2242

OCT. 12, 1994

REWITNESSED WITNESS CORNER TO PROPERTY CORNER IN SECTION 2,
TOWNSHIP 2 NORTH, RANGE 10 WEST, W.M., MAP B-487 STATES NORTH
318.11 & EAST 1324.96 FROM THE SOUTHWEST CORNER SECTION 2.

HISTORY

1963 JOHN CARLICH MAP B-487 SET BRASS DISC. FOR W.C. 3.02'
EAST OF TRUE COR.
AND MARK TWO BEARING TREES:

BT, HEM., 27", S 71° W, 4.3'

BT, HEM., 12", N 27° E, 10.0'

OCT. 12, 1994 I FOUND 3" BRASS DISC ON 1" IRON PIPE STAMPED "CZ
#287 9/63". IN GOOD SHAPE, FROM WHICH:

27" HEM. STUMP WITH SCRIBING VISIBLE BEARS (S 71° W 4.3 FEET);

NEW ACCESSORYS

I SCRIBED A 12" D. FIR TREE "X BT" ON LOW BLAZE, BEARS N 59° E
18.79 FEET TO BRASS NAIL AND WASHER STAMPED "LS 2507" BETWEEN THE
"B" & "T"

I SCRIBED A 13" D. FIR TREE "X BT" ON LOW BLAZE, BEARS S 35° E
3.91 FEET TO BRASS NAIL AND WASHER STAMPED "LS 2507" BETWEEN THE
"B" & "T"

I DROVE A STEEL FENCE POST 3.02' WEST OF WITNESS CORNER BRASS CAP.

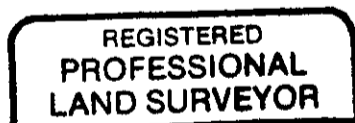

Terry L. Jones

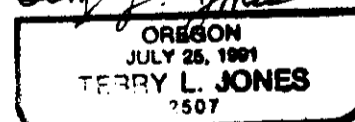

RENEWAL DATE 6-30-95

